

**UNIVERSITY OF THE PACIFIC,
ARTHUR A. DUGONI
SCHOOL OF DENTISTRY**

**DENTAL CANDIDATE
INFORMATION SHEET**

WESTERN REGIONAL EXAMINING BOARD
(June 10-13, 2022)

The University of the Pacific, Arthur A. Dugoni School of Dentistry is making its facility available to the Western Regional Examining Board (WREB) as a testing site only. This handout is intended to address questions you may have regarding the facility and its role in the examination. If you need any additional information or clarification, please contact Jennifer McGlothlin at (415) 929-6445 Email: jmcglathlin@pacific.edu However, please do not call the school for any interpretation of material contained in your Candidate Manual. Questions regarding the examination itself (content, patient requirements, paperwork/forms, etc.) should be directed to the WREB office at 623-209-5400, Option 1.

HOTELS

There are many hotels in downtown San Francisco relatively close to the school. Some hotels listed below are within 3-6 miles from downtown. Please search for additional accommodations:

WESTIN	335 POWELL STREET	(415) 397-7000
MARRIOTT	480 SUTTER STREET	(415)398-8900
HOTEL ZETTA	55 – 5 TH STREET	(415) 543-8555
INTERCONTINENTAL HOTEL	888 HOWARD STREET	(415) 616-6500
HILTON	333 O’FARREL STREET	(415) 771-1400
COMFORT INN by the Bay	2775 VAN NESS AVENUE	(415) 928-5000
COVENTRY MOTOR INN	1901 LOMBARD STREET	(415) 567-1200
COW HOLLOW MOTOR INN	2190 LOMBARD STREET	(415) 921-5800
DE VILLE MOTEL	2599 LOMBARD STREET	(415) 346-4664
EDWARD II INN	3155 SCOTT STREET	(415) 922-3000
LANAI MOTEL	2361 LOMBARD STREET	(415) 931-7810
MANOR MOTEL	2358 LOMBARD STREET	(415) 922-2010
S.F. MOTOR INN	1750 LOMBARD STREET	(415) 921-1842
MIYAKO HOTEL	1625 POST STREET	(415) 533-4567
BEST WESTERN	1800 SUTTER STREET	(415) 921-4000
HOLIDAY INN	PINE AND VAN NESS	(415) 441-4000
BROADWAY MANOR INN	2201 VAN NESS AVENUE	(800) 727-6239
THE QUEEN ANNE	1590 SUTTER STREET	(800) 227-3970

Please contact your choices directly for information about room rates, and facilities. **Do not call the school for this information. Please note this list is for your convenience. We do not recommend one over the other.**

DIRECTIONS TO THE SCHOOL OF DENTISTRY

The School of Dentistry is located at 155 – 5th Street. (See map on page 12) Entrance into the exam will be on Fifth Street. This entrance is mid-way between Howard and Minna Street. For the examination, we are asking all candidates and patients to enter and exit ONLY from this entrance.

From the East Bay

Take Highway 80 west bound across the Bay Bridge. Take the Fifth Street exit off Highway 80. Turn slight right onto 5th Street. Proceed down 5th Street to the corner of Mission and 5th. There is a parking garage on the corner of 5th and Mission.

From the Peninsula/South Bay

From San Francisco Airport, take 101 North to San Francisco. Take the Seventh Street exit. Make a left on Seventh; make a right on Folsom to 5th Street; make a left on 5th Street. There is a parking garage on the corner of 5th and Mission.

Coming from 280 North... Take 6th Street exit; Proceed down Sixth Street to Folsom; Turn right on Folsom for one block and make a left on 5th Street.

If you plan to take Bart, we are located 2 blocks off Market where the Powell Street Station is located.

PARKING

There is a public parking lot located on the corner of Fifth and Mission across the street from the school with hourly rates. We do not validate parking.

Street parking is limited to metered parking and the fine for overtime parking is quite expensive.

FOOD/LUNCH FACILITIES

We will not be offering food service in the building on the weekend. There are many outside food establishments all around our School. At the Westfield Shopping mall, located at 5th and Mission, there is a food court with a variety of eateries available.

EQUIPMENT AND SUPPLIES

The following clinic supplies will be furnished during the examination:

MATERIALS PROVIDED FOR OPERATIVE SIMULATION EXAM		
Matrix Bands	Amalgam (Capsules)	Amalgamator
Wedges	Curing Light	Matrix Tweezer, Forcep, and Clamp
Rubber Dam	Composite Gun	Tofflemire Band
Etch	Polishing points	Articulating paper
Bond	Finishing Strips	Air/Water tips
Flowable Composite	Floss	2x2 cotton gauze
Packable Composite	#15 Blade	Sectional matrix system
Autoclave Tape	Deck Paper	Disinfectant
Face Masks	Gloves	Instrument Trays (disposable or metal)
Soap	Trash Bags	Tray Covers
Paper Towel	Disposable Gowns	

EQUIPMENT RENTAL

All instruments, handpieces, and materials are included with your school usage/facility fee (paid for when you registered for the exam). If you have any questions regarding these items, please contact Fayyaz Ibrahim at (415) 351-7141 email fibrahim@pacific.edu

The **Endodontic** portion of the examination will be given in our Simulation Laboratory on the 5th floor. The teeth* will be mounted in Acadental ModuPro arches, model #E120mQR. The arches will be magnetic mounted onto a typodont and placed into a simulator head. Shrouds will be used. Our bookstore will be able to take orders or have available to purchase the Endo arches. Our bookstore number is (415) 929-6467 or visit our website at www.dentalstudents.com. The School teaches lateral condensation, so the supplies furnished for the examination are listed below:

Chloroform	Gutta percha
Sodium Hypochlorite	Irrigation syringe
Files (#8-#70)	Paper points
Gates Glidden	Endo sealer
Gauze sponges (2 x2)	ProLube
Cavit	

There will be multiple x-ray units in the Simulation Laboratory. Our technicians will be printing post op digital x-rays for submission.

*Please refer to the WREB Dental Candidate Guide for ENDO exam requirements in 2022.

The **Prosthodontic** portion of the examination will be given in our Simulation Laboratory on the 5th floor. The teeth* will be mounted in Acadental ModuPro arches, model #E120mQR. The arches will be magnetic mounted onto a typodont and placed into a simulator head. Shrouds will be used. You will need to provide the mandibular ModuPRO One arch. WREB will provide the maxillary ModuPRO One arch to be treated. Our school will provide the PVS putty material during the exam.

*Please refer to the WREB Dental Candidate Guide for Prosthodontic exam requirements in 2022.

CLINIC OPERATORY EQUIPMENT

Each clinic operatory is equipped with a new Pelton-Crane unit, with operator and assistant chairs. There is no need to request for a left-handed user chair because our units can be adjusted for either. Our units are fitted for Bien Air electric handpieces and Kavo electric handpieces. We also have air-driven handpieces if you prefer.

There will be no storage areas available for your equipment and personal items in the clinic or the laboratories. You will need to bring and take your dental equipment with you every day.

EQUIPMENT MALFUNCTIONS

We will have technicians from our Building Operations available all day if you experience operatory equipment malfunction.

Please note: if you choose to bring your own handpieces, we cannot repair them. Any equipment or instruments you bring into our facility must be sterile.

DISPENSARY/STERILIZATION

Our Dispensary windows will be open all day for service. There is a dirty intake window linked with the dispensary area. All dirty instruments must be turned in after each procedure for processing.

You are permitted to get up and get additional instruments or materials at any point throughout the exam.

EMERGENCY PROTOCOLS

The examiner will have access to the school's automatic external defibrillator (AED) and provide appropriate action according to the American Heart Association (AHA) standards until emergency responders arrive.

For the management of dental emergencies at our School, a medical crash cart is stationed in our Oral Surgery Department and on the 2nd floor corridor. A faculty member will be on call throughout the course of the examination. If you should experience any type of medical emergency, notify UOP staff or WREB examiners immediately.

INFECTION CONTROL

Universal Precautions - The School of Dentistry requires the use of universal barrier protection (gloves, face masks, eyewear with side shields, and protective clothing during all direct patient contact. Barrier covers, nitrile gloves, side shields for eyewear, and facemasks will be made available, but you will be responsible for providing OSHA-acceptable eyewear for yourself and your dental assistant.

Clinic Attire – You must provide your own clinic attire, which must meet any standards imposed by WREB. Disposable gowns will be available for your use.

Surface Asepsis – Each operatory will have disinfectant wipes available for surface disinfection of the clinic operatory (patient chair, operator and assistant carts/tools, light handles, counter tops, etc.).

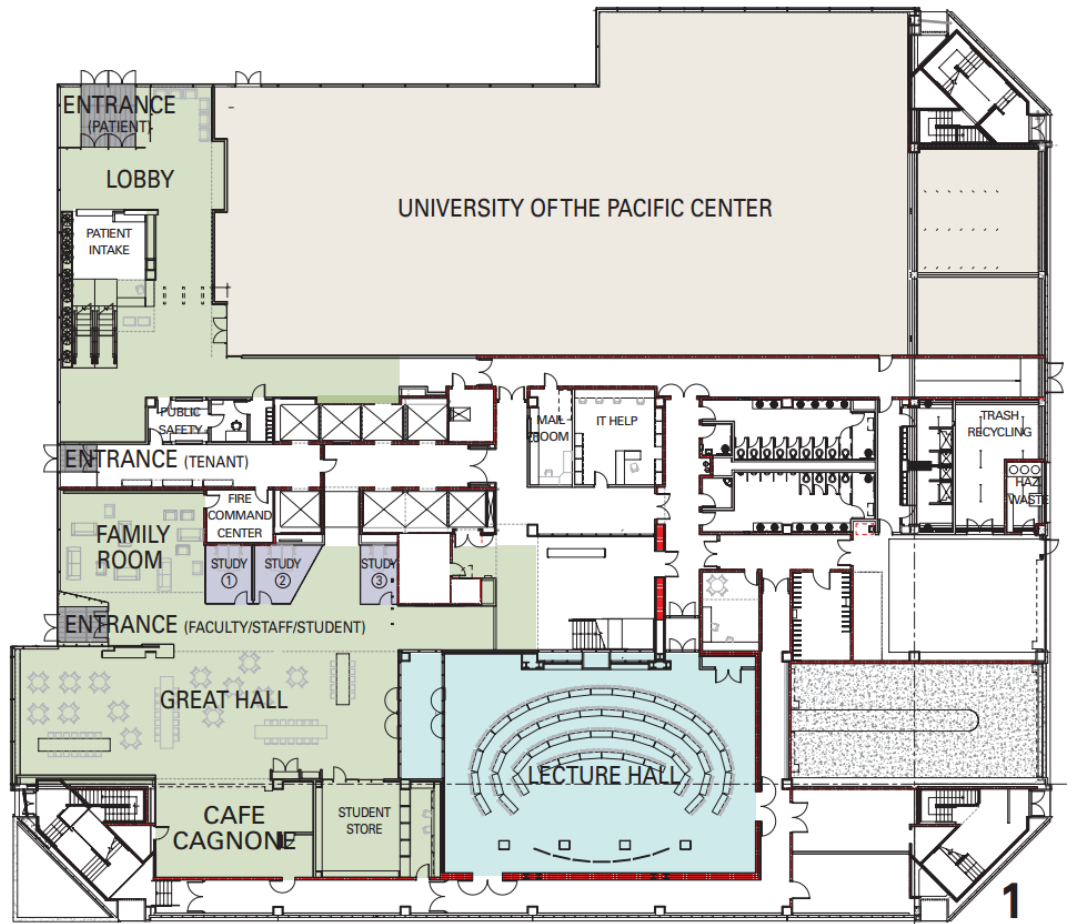

First Floor

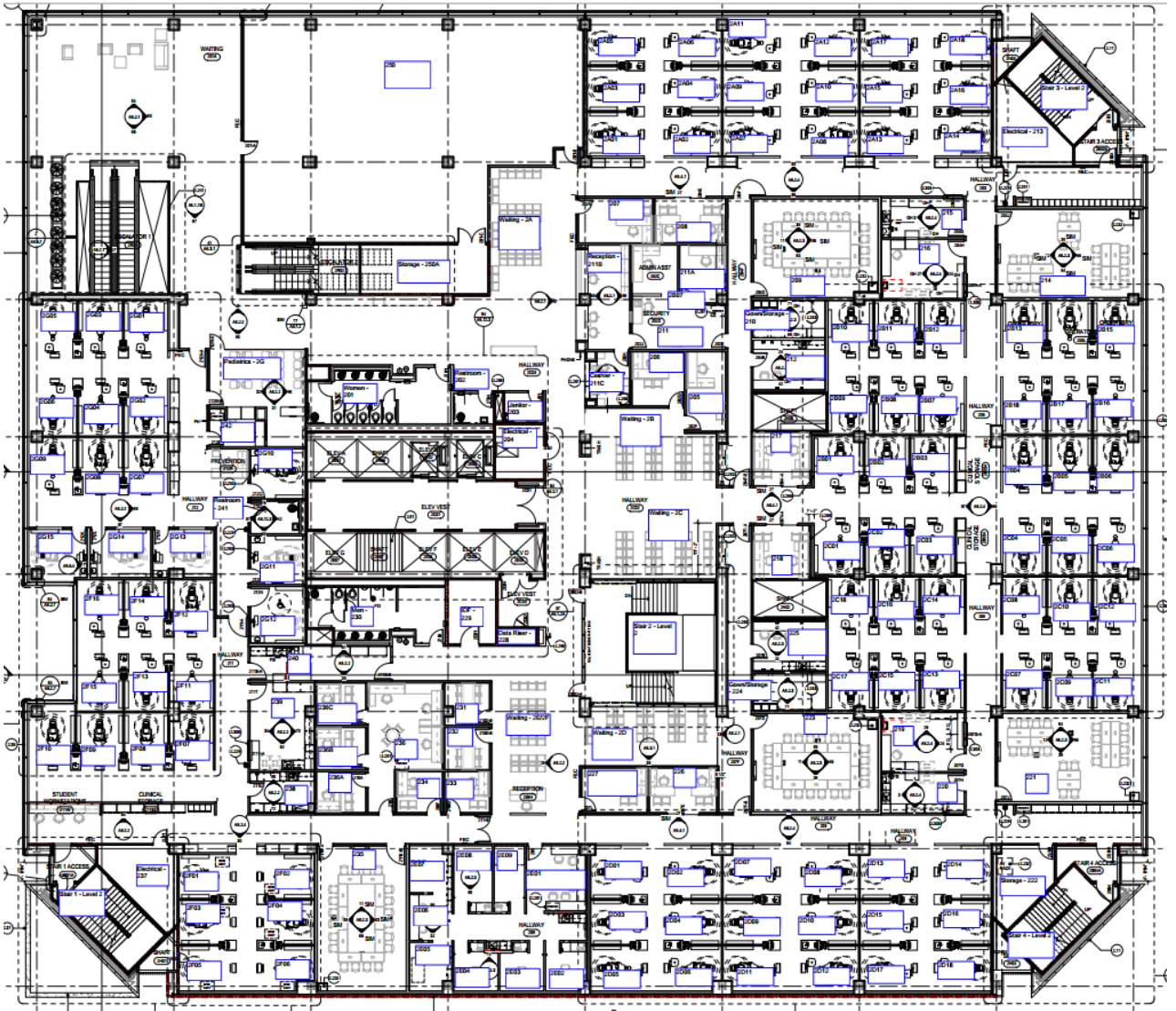

Second Floor



Fifth Floor

Google Maps University of the Pacific, Arthur A. Dugoni School of Dentistry

